



Improved

SELION C21 HD

LIGHTWEIGHT, ACCURATE PRUNER FOR INTENSIVE USE

Easy to use, powerful, and lighter than any of its competitors, when it comes to power and precision the Selion C21 HD pruner will satisfy all your requirements.

With enough battery life for a full day of work, it has been designed to facilitate the work of pruners and reduce the strain on the user. The Selion C21 HD pruner model has many innovative features which make it a vital tool for professionals seeking to combine safety, handling, and power.



Commendation in the "New Technologies" category
EIMA-FEDER UNACOMA - 2014

Innovation Award
SMCL EXHIBITION FOR FRENCH MAYORS AND LOCAL AUTHORITIES - 2009

SELION C21 HD

SELION C21 HD - THE ESSENTIALS

Testimonial



LIGHTWEIGHT



PRODUCTIVE



SAFE



ERGONOMIC

If it didn't exist, I'd have a real problem. I've been using this equipment for the last five years, and I still find it revolutionary. After 25 years in the business, I couldn't work with the petrol models any more, it was costing me too much on every level. Now I get reliability, lightness, quietness, ease of handling, aesthetics, and all without gas pollution — this is exactly what I needed.

Moustapha Bounzel,
Tree surgeon - Au Bonheur des Arbres,
Montpellier, France



LIGHTWEIGHT

- Only 2,55 kg - Perfect for tree-climbing arborists.

PRODUCTIVE

- Extremely powerful with the PELLENC 2000 W Brushless motor (equivalent to a 45 cc petrol motor, but the PELLENC motor produces more torque).
- A guide that tightens the chain tension for optimal operation.
- Allows easy removal of wood shavings with its magnesium alloy casing, thus preventing jamming.
- Cost-effective: reduces chain oil consumption by 30%.
- Provides tree surgeons with enough battery life for a full day of pruning.
- Low maintenance
- The lateral chain tensioner makes it easy to adjust the chain tension.
- Automatic chain tensioning.

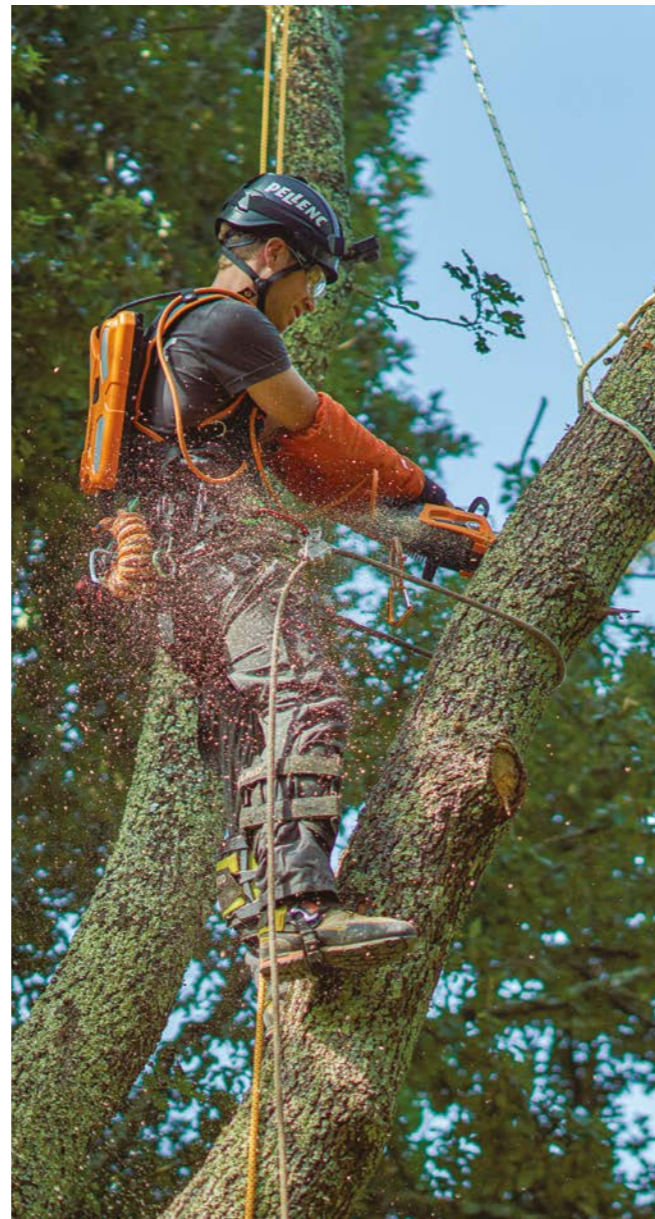

SAFE

- **NEW** With the quick connector system, the tool can be quickly plugged into or out of the battery during work sessions. This key safety feature lets you bring up the pruner once you are in position in the tree.
- The grip notch enables a more solid grip on branches and trunks.
- Automatic electric chain brake in case of fall or kickback.
- Less risk of kickback compared to a conventional chainsaw.
- Reinforced front hand guard.

ERGONOMIC

- Soft Touch ergonomic handle for greater comfort.
- Quiet operation, facilitating use for extended periods.
- **NEW** Cutting software: the chain slows down when it is in the wood, which allows the user to better dose the applied force and so keep the motor from locking.



PRODUCT ADVANTAGES



2-YEAR WARRANTY



Casing

The magnesium casing improves the evacuation of wood shavings and provides greater stability and lightness.



Claw

Enables a firmer grip on branches and trunks.



Quick connector system

The tool can be quickly plugged into or out of the battery during work sessions. This key safety feature lets you bring up the pruner once you are in position in the tree.



Safety

PELLENC has developed 4 innovations to help protect the user:

1. The electronically triggered kickback sensor instantly engages the electric chain brake in the event of a fall or kickback, and is eight times more sensitive than the chain brake of a petrol chainsaw.
2. With the OREGON chain, the kickback effect—if it occurs—will be much less abrupt than on a conventional chainsaw.
3. The tool's self-diagnostic system frequently checks that the electronic kickback sensor is operational. If so, the tool can operate.
4. The double-press start-up trigger prevents accidental start-up of the chainsaw.

THE ADVANTAGES OF PELLENC



Automatic chain tensioning

The chain guide is mounted on a patented mechanism that tightens the chain automatically.

PELLENC patent



Electronically managed oil flow

The system adjusts the lubrication of the chain based on the required cutting strength.

PELLENC patent

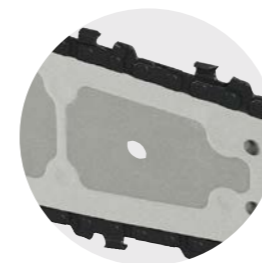

Electronic chain brake

The chain brake instantly activates in the event of a fall or kickback.

PELLENC patent



Tightening wrench

This wrench lets the user tighten the chain and provides quick access to the sprocket and the chain.

PELLENC patent

- ▶ 3D animation
- ▶ Marketing Video

ACCESSORIES & CONSUMABLES

11" - 28 CM STANDARD LIGHT GUIDE

28-cm guide made of composite material.



Sold as standard - ref: 72884

11" - 28 CM CARVING GUIDE

28-cm profiled guide for cutting and sculpting wood



ref: 80344

1/4" - 25AP - 1.3 MM - 70E OREGON CHAIN

Anti-kickback chain.



Sold as standard - ref: 81794

10.4" - 27 CM PRECISION GUIDE

27-cm guide that improves work efficiency.



ref: 145550

PRECISION CHAIN 1/4" - 1.1MM - 67E

Chain that reduces the effort required in cutting.



ref: 145589

SHARPENING KIT

Round file - Flat file - Chain threader



ref: 68520
Available from late 2019

BIODEGRADABLE CHAINSAW OIL

Biodegradable chain oil.
5-litre jerrycan.



ref: 116688

TECHNICAL FEATURES

	SELION C21 HD
Max. power - W	2,000
Combustion engine equivalence - cc	45
Weight - kg	2.55
Motor speed - rpm	6,200
Chain speed - m/s	14.5
Guide length - cm/inches	28 / 11"
OREGON chain	
Pitch	¼"
Type / Gauge / Number of links	25AP / 1.3 mm / 70E
Sprocket	11 x ¼" teeth
Tank capacity - cl	25
Sound pressure level (L _{PA})* - with K uncertainty KpA = 3.0 dB(A)	84
Guaranteed sound power level (L _{WA})**	98
Vibration level (a _v)* - with K uncertainty = 1.5 m/s ²	≤ 2.5
Battery life with the Alpha 520 battery***	Up to 4-5 hrs
Peristaltic pump	•
Automatic chain tensioner	•
Integrated folding wrench	•
Electronic chain brake	•

* As standard * Noise and vibration measurements according to EN 60745-1 and EN 60745-2-13.

** According to Directive 2000/14/EC.

*** For information purposes: the times were observed in actual working time, including breaks.
Battery life is influenced by the nature of the work required.